



# NAPA VAULT

## SITE PLAN



— = Structural wall  
- - = Demising wall

 Phase 1 (43 units)  
*\*completed*

 Phase 2 (30 units)  
*\*mid 2023*

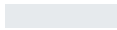
 Phase 3 (43 units)

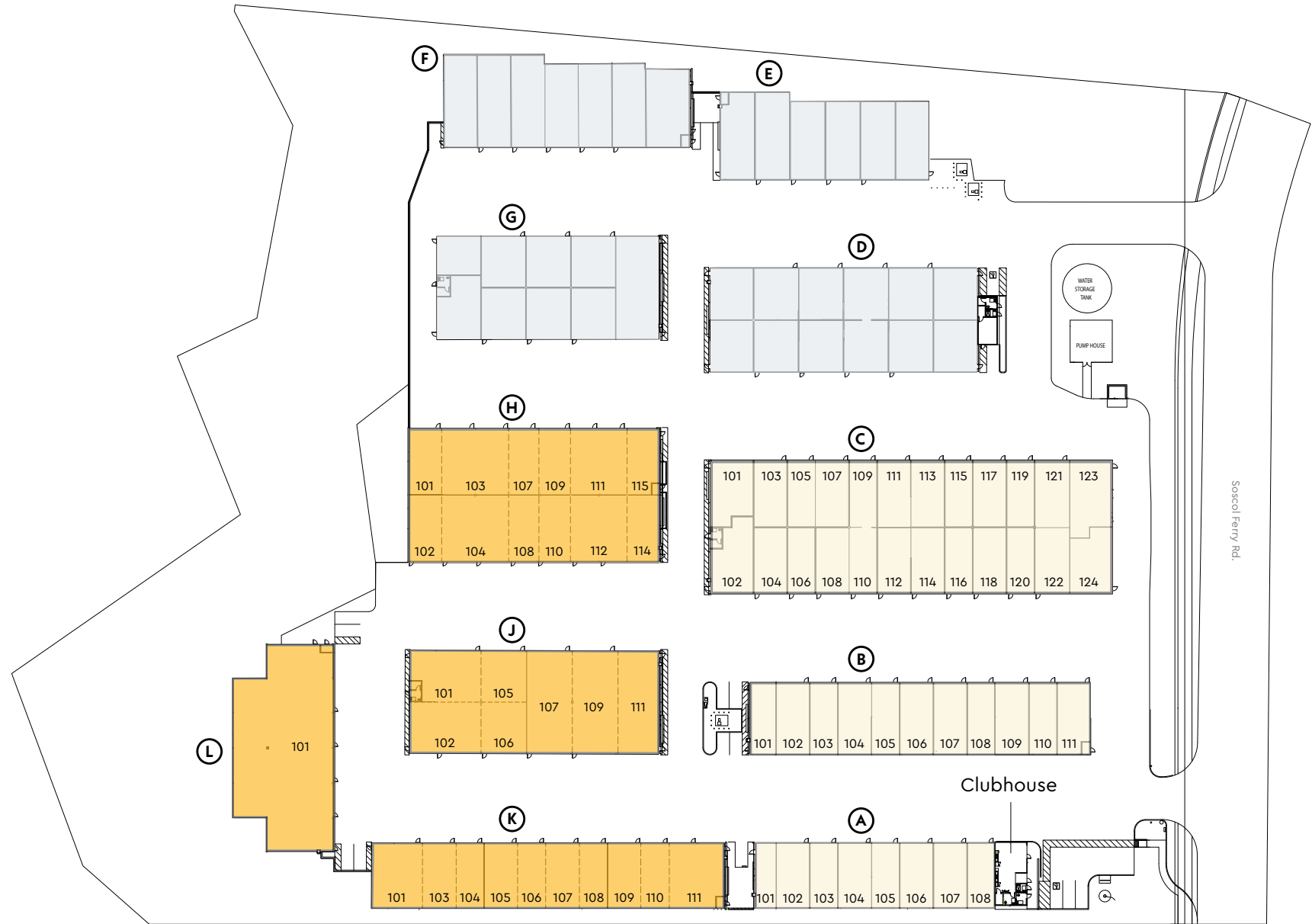

Soscol Ferry Rd.

Clubhouse

 415.686.0255

 [Laura.Duffy@jll.com](mailto:Laura.Duffy@jll.com)

 Laura Duffy CA Lic# 01922792

The square footage and individual dimensions shown on this plan are approximate. They may vary for any number of reasons after the units are built and are not guaranteed by the developer.

Jones Lang LaSalle Brokerage, Inc. Real Estate License #: 01856260 ©2023 Jones Lang LaSalle IP, Inc. All rights reserved. All information contained herein is from sources deemed reliable; however, no representation or warranty is made to the accuracy thereof.

 [NapaVault.com](http://NapaVault.com)

 1055 Soscol Ferry Rd / Napa, CA 94558



# NAPA VAULT

## Building A Units A101-108

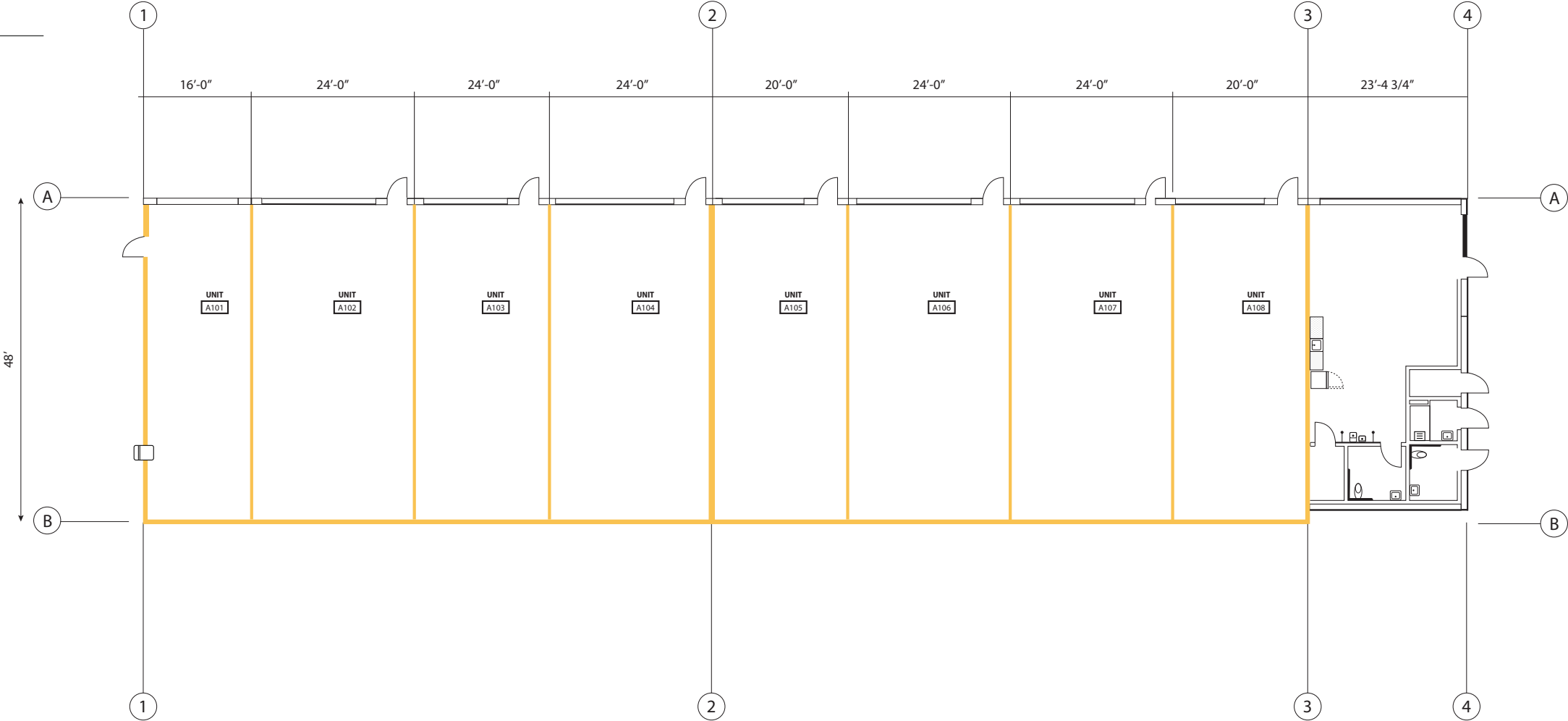

415.686.0255

Laura.Duffy@jll.com

Laura Duffy CA Lic# 01922792

NapaVault.com

1055 Soscol Ferry Rd / Napa, CA 94558

The square footage and individual dimensions shown on this plan are approximate. They may vary for any number of reasons after the units are built and are not guaranteed by the developer.

Jones Lang LaSalle Brokerage, Inc. Real Estate License #: 01856260 ©2023 Jones Lang LaSalle IP, Inc. All rights reserved. All information contained herein is from sources deemed reliable; however, no representation or warranty is made to the accuracy thereof.

  
NAPA VAULT

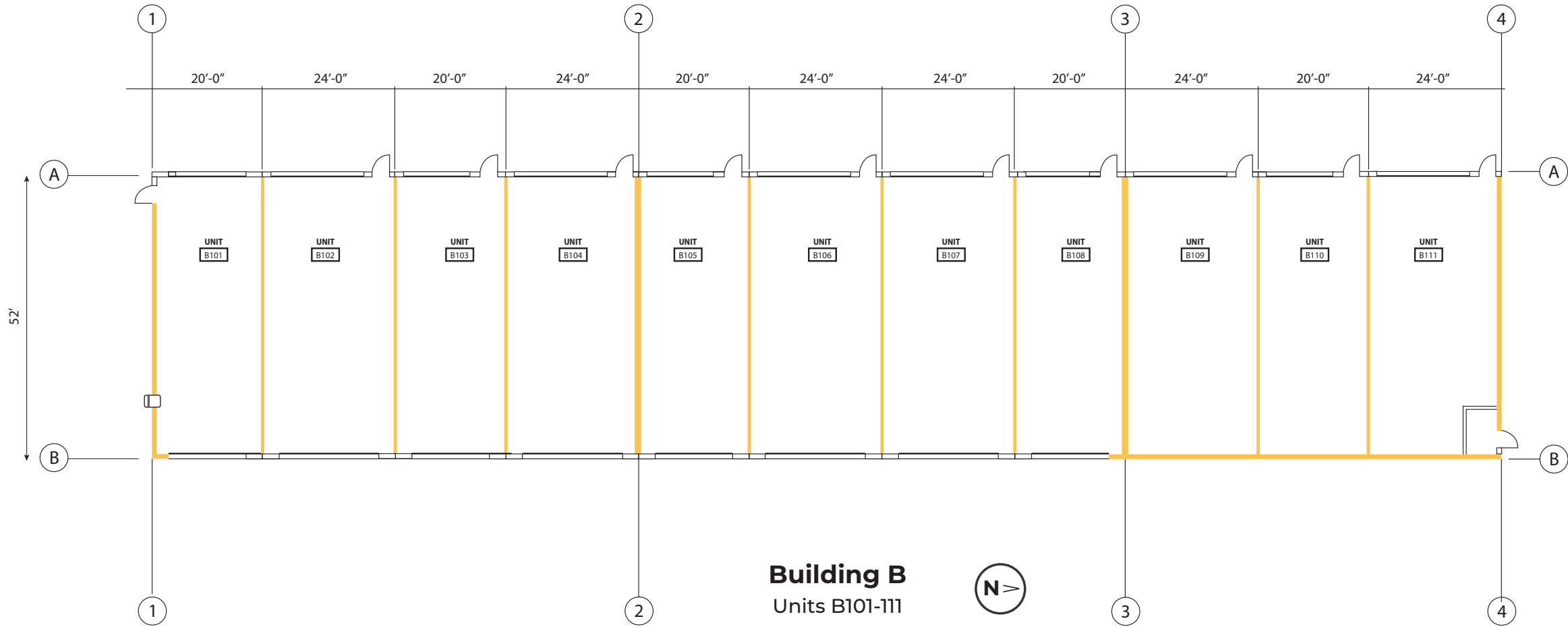

 415.686.0255

 Laura.Duffy@jll.com

 Laura Duffy CA Lic# 01922792

The square footage and individual dimensions shown on this plan are approximate. They may vary for any number of reasons after the units are built and are not guaranteed by the developer.

Jones Lang LaSalle Brokerage, Inc. Real Estate License #: 01856260 ©2023 Jones Lang LaSalle IP, Inc. All rights reserved. All information contained herein is from sources deemed reliable; however, no representation or warranty is made to the accuracy thereof.

 NapaVault.com

 1055 Soscol Ferry Rd / Napa, CA 94558



**Building C**  
Units C101-112

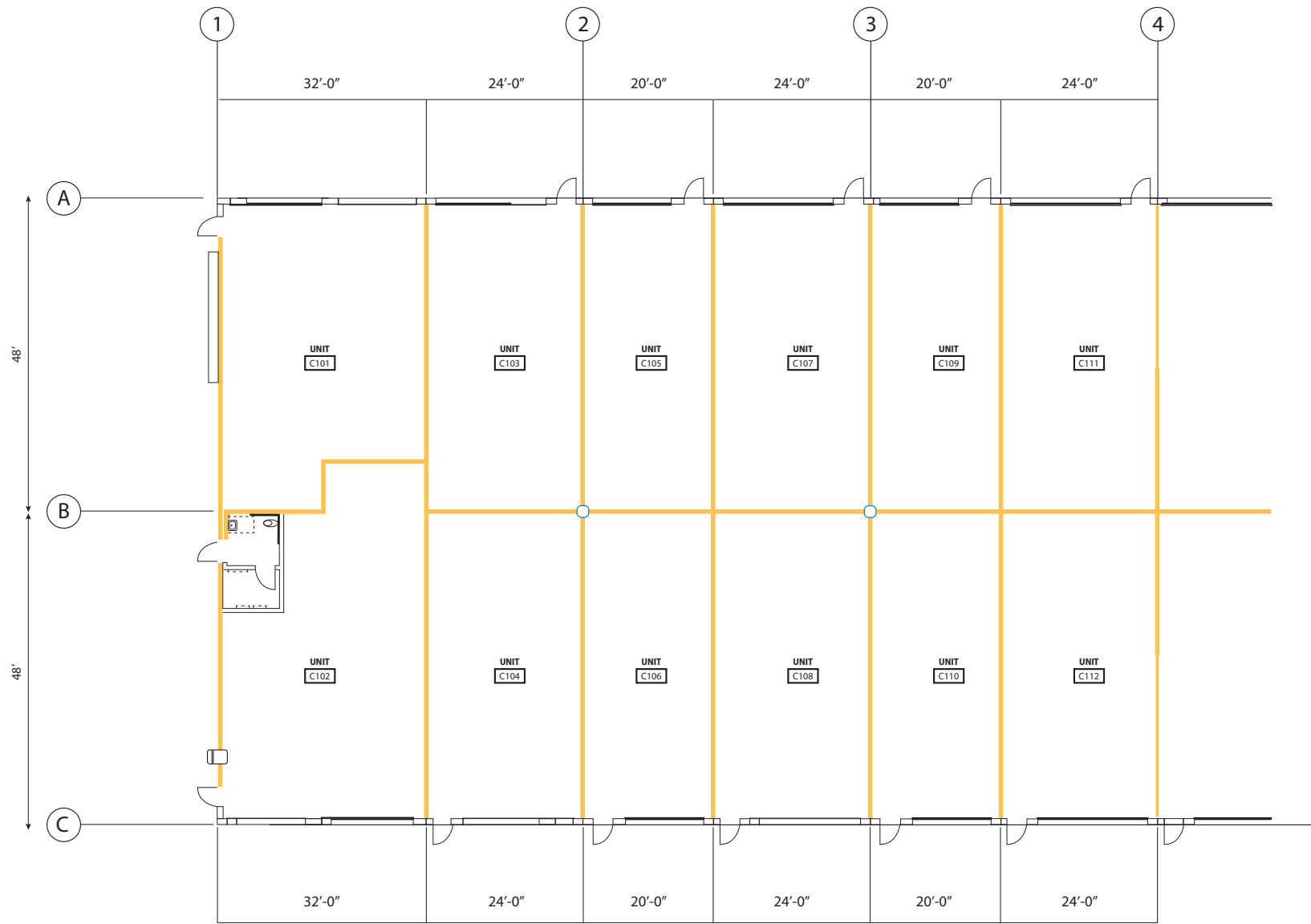

 415.686.0255

 [Laura.Duffy@jll.com](mailto:Laura.Duffy@jll.com)

 Laura Duffy CA Lic# 01922792

 [NapaVault.com](http://NapaVault.com)

 1055 Soscol Ferry Rd / Napa, CA 94558

The square footage and individual dimensions shown on this plan are approximate. They may vary for any number of reasons after the units are built and are not guaranteed by the developer.

Jones Lang LaSalle Brokerage, Inc. Real Estate License #: 01856260 ©2023 Jones Lang LaSalle IP, Inc. All rights reserved. All information contained herein is from sources deemed reliable; however, no representation or warranty is made to the accuracy thereof.



**Building C**  
Units C113-121

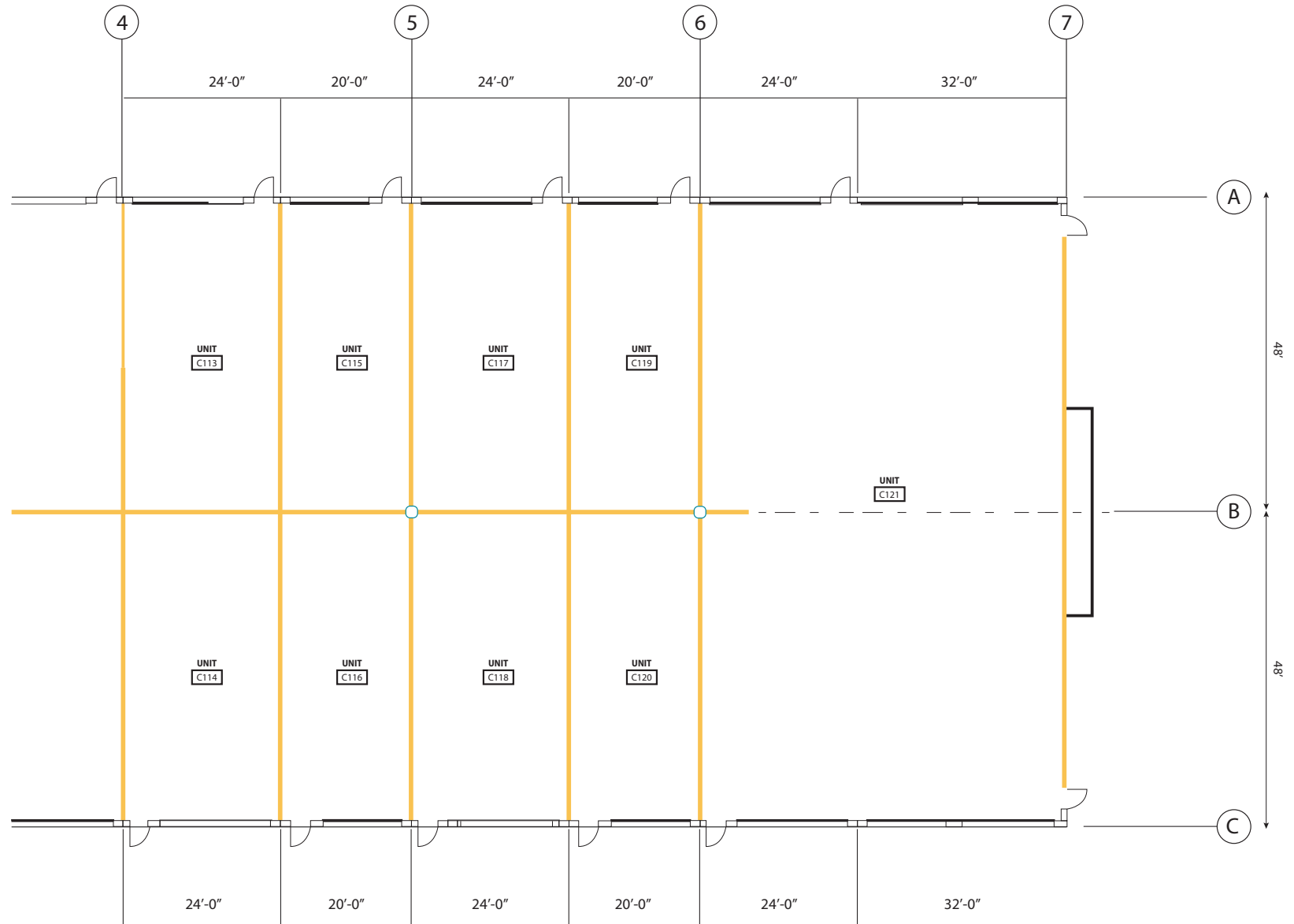

415.686.0255

Laura.Duffy@jll.com

Laura Duffy CA Lic# 01922792

The square footage and individual dimensions shown on this plan are approximate. They may vary for any number of reasons after the units are built and are not guaranteed by the developer.

NapaVault.com

1055 Soscol Ferry Rd / Napa, CA 94558

Jones Lang LaSalle Brokerage, Inc. Real Estate License #: 01856260 ©2023 Jones Lang LaSalle IP, Inc. All rights reserved. All information contained herein is from sources deemed reliable; however, no representation or warranty is made to the accuracy thereof.



# NAPA VAULT

## Building K Phase 2 | Units K101-111

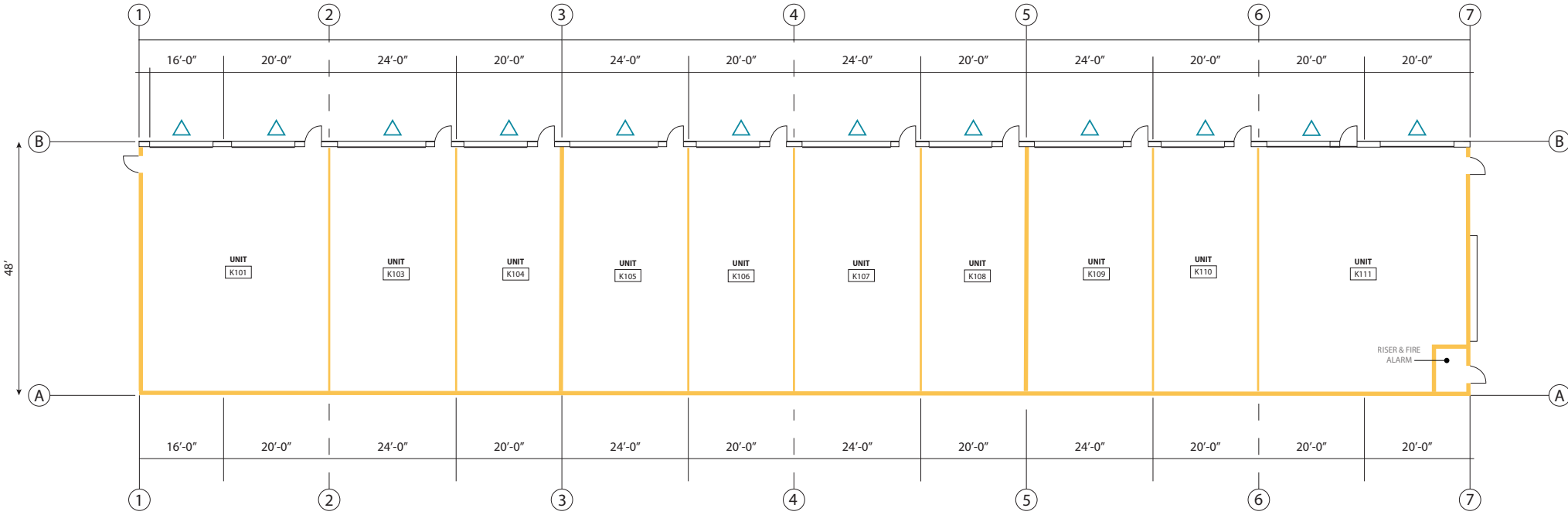

 = Grade level roll up door

 415.686.0255

 [Laura.Duffy@jll.com](mailto:Laura.Duffy@jll.com)

 Laura Duffy CA Lic# 01922792

 [NapaVault.com](http://NapaVault.com)

 1055 Soscol Ferry Rd / Napa, CA 94558

The square footage and individual dimensions shown on this plan are approximate. They may vary for any number of reasons after the units are built and are not guaranteed by the developer.

Jones Lang LaSalle Brokerage, Inc. Real Estate License #: 01856260 ©2023 Jones Lang LaSalle IP, Inc. All rights reserved. All information contained herein is from sources deemed reliable; however, no representation or warranty is made to the accuracy thereof.